

METAL CABLE BRACKETS

Mounted on 19" vertical extrusions and used for vertical cable management in racks.

Description:

- For vertical cable management
- Dimensions 100x140mm
- Flange with 4 holes for installing on front or side of 19" vertical extrusion
- Zinc plated
- Each code contains 10pcs of brackets
- Front or side cable entry

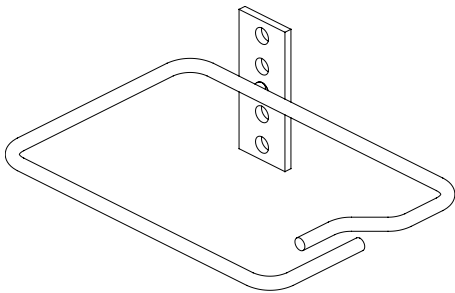
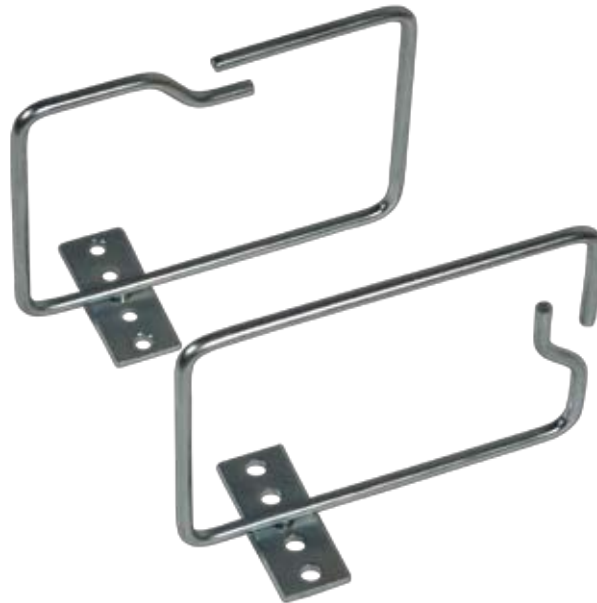

VO-W1-100/140 - side cable entry

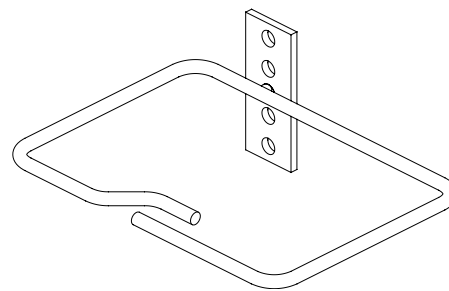

VO-W2-100/140 - front cable entry

METAL CABLE BRACKETS				
Code	Dimensions in mm		Cable entry	Qty
	W	D		
VO-W1-100/140	140	100	side	10 pcs
VO-W2-100/140	140	100	front	10 pcs